

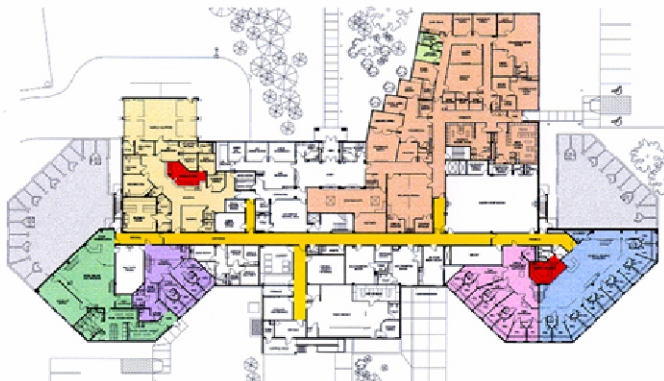

Benton County constructed a Sheriff's Office and Jail that was master planned to accommodate a future courts complex. The core facility was constructed to support a future capacity of 125 inmates. The General Population unit has 24 beds. The 16-bed Special Management area is divided into four separate units, each with good visibility from Central Control and the unit workstation. The Work Release/Sentenced to Serve (STS) housing unit has a dorm capacity of 24 which can operate either in or out of the secure perimeter. A separate secure entrance and an indoor/outdoor multi-purpose room were created to serve both male Work Release/STS housing or Female Housing which consists of three units.

The booking and release area has a drive-through vehicle sallyport, double entry isolation cell, holding cells, property room, and areas for shift supervisor and transport officers. Non-contact family visits occur at the housing unit by bringing visitors to housing through a secure, second-level corridor. Program space includes two multi-purpose rooms, library, and classrooms. Support space includes food service, commissary, laundry, and maintenance.

The Sheriff's Office is connected to the Jail by a security vestibule. Shared spaces include locker rooms, multipurpose rooms, training, and meeting spaces. The investigators and road patrol deputies share interview rooms. There are five distinct spaces within the Sheriff's area - office of the Sheriff, road patrol, investigations, dispatch, and juvenile holding in addition to the shared spaces. The lower level includes parking, property management (evidence), storage, and an indoor range.



Benton County Sheriff's Office and Jail Foley, Minnesota



Voorhis Associates, Inc. developed the needs assessment and pre-architectural programs, assisted with design, and provided transition guidance. The project was initiated with a needs assessment to determine if the current four-bed facility and purchase of contract beds should be continued versus construction of a new facility. A life cycle cost analysis led the county policy makers to plan for a new facility.

We assisted the architect in translating the pre-architectural program into a staff efficient design.

Voorhis Associates also guided the transition process.



Beds:
72

Project Cost:
\$9,925,000

Completion Date:
1996



VOORHIS ASSOCIATES, INC.
201 ELM STREET, MINNEAPOLIS, MN 55401-3036 TEL: 612-338-6356 FAX: 612-338-6355